

Facades available:

Callington, Harrogate, Kent	
Lancaster, Sheffield, Swansea	
Wiltshire, Eastwood	
Overall home width	9.05m
Overall home length	18.83m

Residence	107.4m ²	11.6sq
Garage	36.1m ²	3.9sq
Porch	3.0m ²	0.3sq
Total	146.6m²	15.8sq

FLOORPLAN OPTIONS

We personalise our floorplans. Talk to us about our huge range of ready-to-go design options or simply visit www.burbank.com.au/south-australia for more details.

Listed details based on Sheffield facade floorplan (illustrated)

*Copyright conditions. All photos and illustrations are representative only. Floor plans and specifications may be varied by Burbank without notice, the dimensions are diagrammatic only and a Building Contract with final drawings will display correct dimensions and detail. All designs are the property of Burbank and must not be used, reproduced, copied or varied, wholly or in part without written permission from an authorised Burbank representative. Copyright Burbank Australia (SA) Pty Ltd. ABN 96 165 533 406. BLD 266709.

Call 13 BURBANK
Visit burbank.com.au

OPTION ENS1

Provide Ensuite upgrade with wall to wall tiled shower base in lieu of 900mm x 900mm polymarble shower base, delete plaster lined wall to Ensuite/WC and relocate WC toilet and WC/Bath flush panel hinged doors to suit.

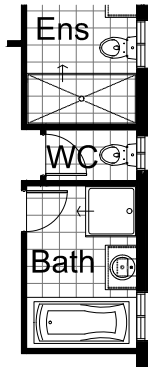

OPTION G1

Provide extension to Garage to create additional Storage area. Increases area by 4.58m². Increases width by 850mm.



OPTION IP1

Provide Real Flame Inspire 900 gas fireplace, 400mm off floor level in a 1400mm x 420mm boxed out plaster wall with a 4 sided black fascia to Family room side wall, relocate Family window by 2880mm and provide additional 1no. 2057mm x 1450mm aluminium sliding window to suit.

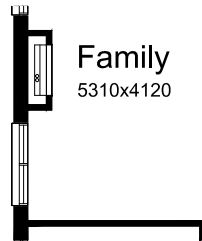

OPTION G2

Provide extension to Garage to create Workshop area including additional window to suit. Increases width by 2400mm. Increases area by 13.51m².



OPTION EP1

Provide Alfresco option with 2no. brick piers and earth floor to Alfresco. Increases area by 12.0m². Increases width by 3000mm.

